

4 Salvation Mews, Swadlincote, DE11 9BN

£825 PCM





MODERN TOWN HOUSE ** SPACIOUS KITCHEN DINER ** TWO BEDROOMS ** BATHROOM ** GARDEN ** PARKING

This property offers gas central heating and double glazing throughout. The spacious ground floor space comprises living room, cloakroom, kitchen diner with Velux windows and on the first floor, a family bathroom with over bath shower and two double bedrooms.

Outside there is a garden to the rear and parking for one vehicle to the front. The property is conveniently situated for access into the town and local amenities.







Floor Plans

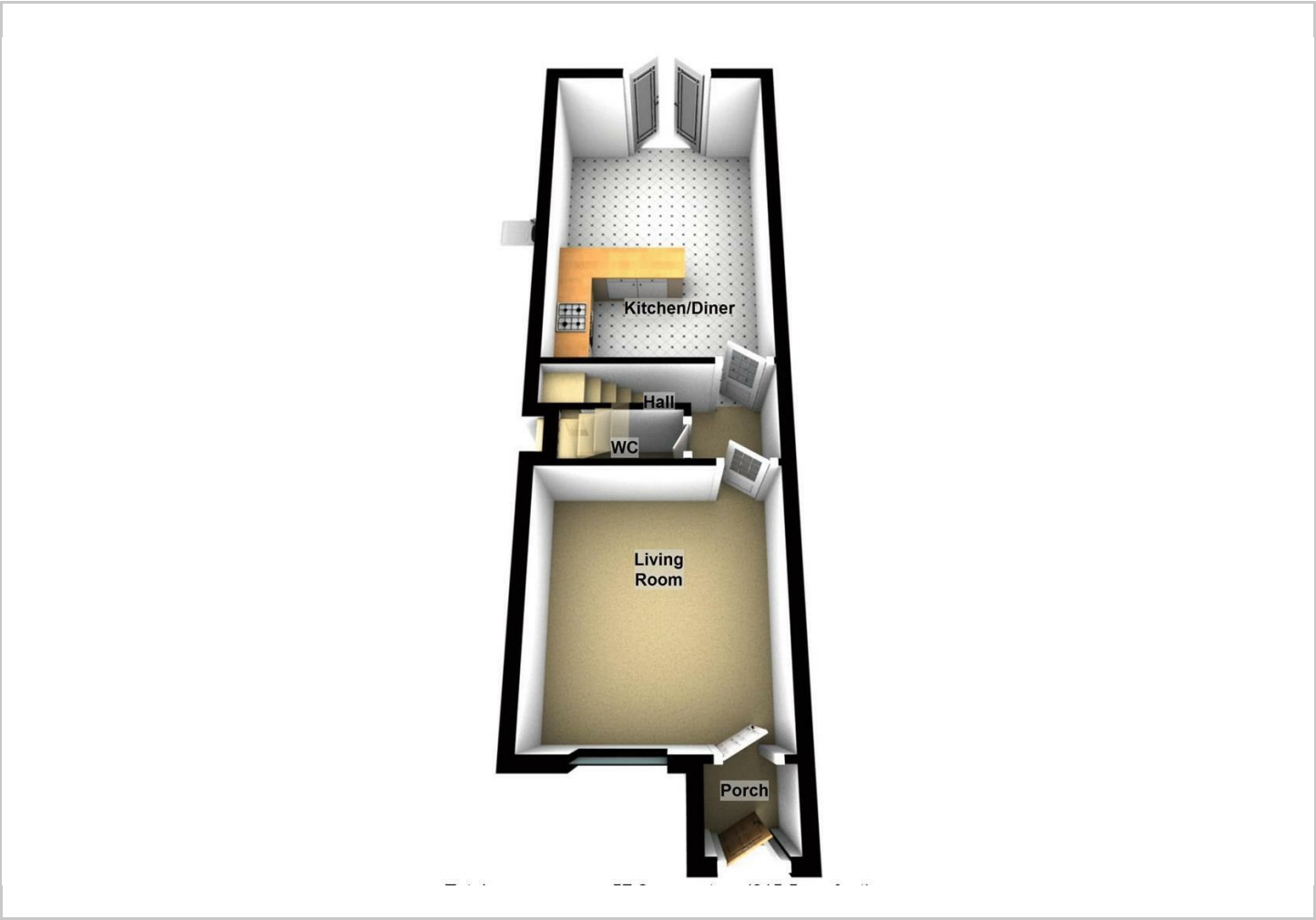

Location Map



Energy Performance Graph

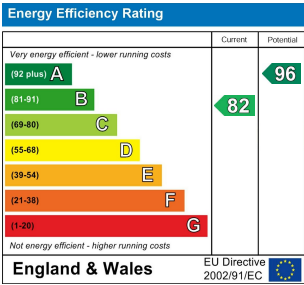

Please contact our Burton Lettings Office on 01283 845888 if you wish to arrange a viewing appointment for this property or require further information.

The particulars are set out as a general outline only for the guidance of intended purchasers or lessees, and do not constitute, any part of a contract. Nothing in these particulars shall be deemed to be a statement that the property is in good structural condition or otherwise nor that any of the services, appliances, equipment or facilities are in good working order. Purchasers should satisfy themselves of this prior to purchasing.